

SECTION A-A
SCALE 1:1

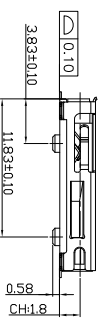

SECTION B-B
SCALE 1:1

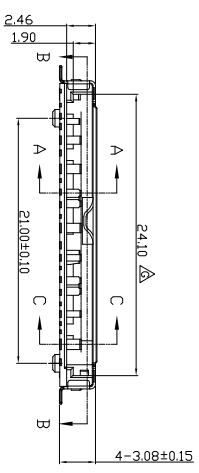
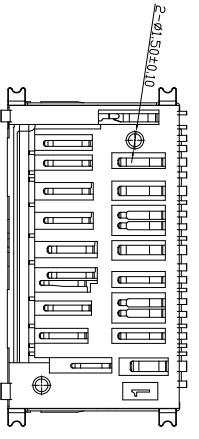
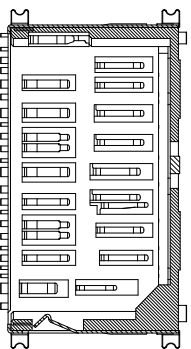

PART NUMBER: JCN-S71G-ULAN-XXX6

Plastic
Color:
A=Blue
B=Black

Gold
Plating:
G=Gold
Flash
A=3u"
B=6u"
C=10u"
D=15u"
E=30u"

Package:
R=Toping
Reel
T=Tary
U=Tube

Note:

- # Specification
- # Electrical Characteristics :
 - Current Rating:0.5A.
 - Withstanding Voltage:AC500V r.m.s.
 - Insulation Resistance:1000Megohms
 - Minimum at DC 500V.
 - Contact Resistance:100Milliohms Maximum.
- # Mechanical Characteristics:
 - Mating Cycles: 10000 Insertions.
- # Environmental :
 - Operating Temperature:-25°C to +85°C.

CHECKED Leon		UNLESS OTHERWISE SPECIFIED TOLERANCE		NAME SD7.0 express Card, Offset 1.8mm, Gold Finish With Shield SMT, Connector	
APPROVED Xv/ef		DIMENSIONAL TOLERANCE		SCALE N/A	
REV. X0		TOLERANCE		UNIT MM	
DRAWN MMDYY		±0.35		SHEET A4	
DRAWN 111021		±0.15		SHEET 1/4	
REVISION RECORD		ANGLE ±5°		MATERIAL/PLATED/LAYERS ①SHIELD : STAINLESS STEEL/NICKEL PLATING ②HOUSING : HIGH TEMPERATURE PLASTIC ③CONTACTS : COPPER ALLOY/NICKEL ④ UNDERPLATED OVERALL GOLD FLASH AT CONTACT AREA/LEAD FREE TIN ALLOY AT TERMINATION.	
NEW DESIGN		DRAWN		PART NO. JCN-S71G-ULAN-XXX6	
REVISION RECORD		DRAWN		DCC. NO. JCN-S71G-ULAN-XXX6	
MARK		DRAWN			

Pin Define

Pin No.	Name	SD Mode	Description	Name	UHS-II Mode	PCIe Mode
Pin 1	CD/DAT3	I/D/PP Cord Detect/Data LineB13	-	-	-	PCIe Mode
Pin 2	CMD	PP Command/Response	Not used	PERST#	I	PC Reset is a functional reset
Pin 3	VSS1	S Supply Voltage	Not used	VSS1	S	Supply Voltage Ground
Pin 4	VDD	S Supply Voltage	Not used	VDD1	S	Supply Voltage Ground
Pin 5	CLK	I Clock	Not used	-	-	Not used
Pin 6	VSS2	S Supply Voltage	Not used	VSS2	S	Supply Voltage Ground
Pin 7	DAT0	I/D/PP Data LineB10	RCLK+	REFCLK+	I	PCIe Ref Clock
Pin 8	DAT1	I/D/PP Data LineB11	RCLK-	REFCLK-	I	PCIe Ref Clock
Pin 9	DAT3	I/D/PP Data LineB12	-	CLKREQ#	I/D/D/D	Reference clock request signal. Also used by L1 PM substates
Pin 10	-	Not used(Connected to Ground)	VSS3	S	Supply Voltage Ground	Supply Voltage Ground
Pin 11	-	Not used	I0+	LVDS	I	Supply Voltage Ground
Pin 12	-	Not used	I0-	LVDS	I	Supply Voltage Ground
Pin 13	-	Not used(Connected to Ground)	VSS4	S	Supply Voltage Ground	Supply Voltage Ground
Pin 14	-	Not used	VDD2	S	Supply Voltage (1.8V)	Supply Voltage (1.8V)
Pin 15	-	Not used	I1-	LVDS	S	Supply Voltage (1.8V)
Pin 16	-	Not used	I1+	LVDS	S	Supply Voltage (1.8V)
Pin 17	-	Not used(Connected to Ground)	VSS5	S	Supply Voltage Ground	Supply Voltage Ground
Pin 18	-	Not used	-	-	-	Supply Voltage (3.3V)
Pin 19	-	Not used	-	-	-	Supply Voltage (3.3V)

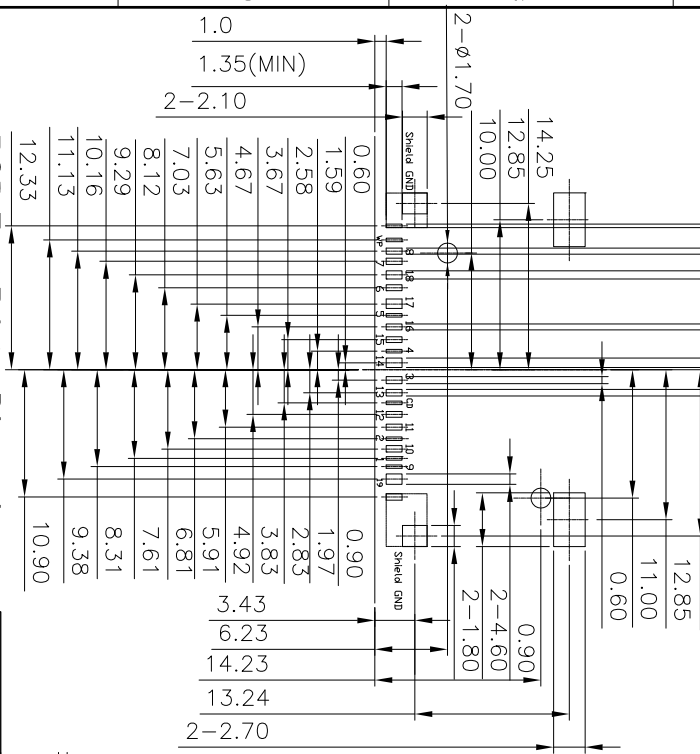

PCB Foot Printer Dimension
TOP VIEW Tolerance: ±0.01mm

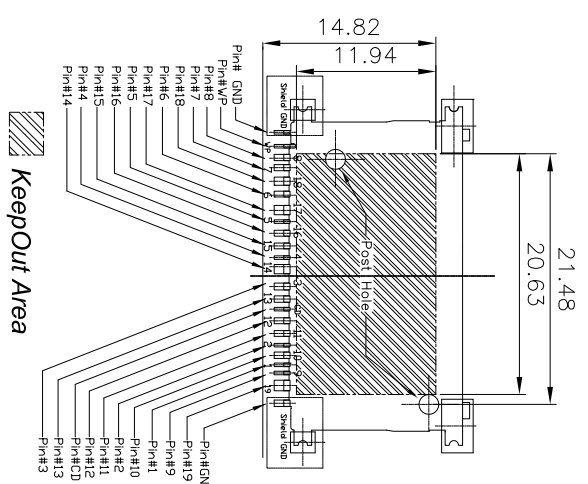

Connector Pin Define Sequence

SMT Stencil Aperture Dimension
TOP VIEW Tolerance: ±0.01mm

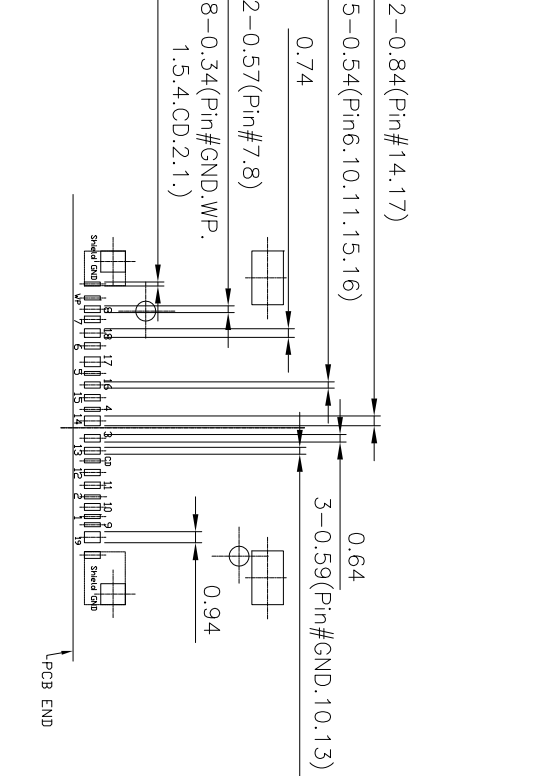

NEW DESIGN	REVISION RECORD	DRAWN	MWDYY	042021																								
MARK	REVISION RECORD	DRAWN	MWDYY	042021																								
<table border="1"> <tr> <td>CHECKED</td> <td>Leon</td> <td>NAME</td> <td>SD7.0 express Card, Offset 1.8mm, Gold Flash with Shield SMT, Connector</td> </tr> <tr> <td>APPROVED</td> <td>Xavier</td> <td>SCALE</td> <td>1:1</td> </tr> <tr> <td>UNLESS OTHERWISE SPECIFIED TOLERANCE</td> <td>Dimension Tolerance</td> <td>UNIT</td> <td>mm</td> </tr> <tr> <td>XXX</td> <td>±0.25</td> <td>SHEET</td> <td>2/4</td> </tr> <tr> <td>XXX</td> <td>±0.15</td> <td>SIZE</td> <td>A4</td> </tr> <tr> <td>XXX</td> <td>±0.15</td> <td>ANGLE</td> <td>5°</td> </tr> </table>					CHECKED	Leon	NAME	SD7.0 express Card, Offset 1.8mm, Gold Flash with Shield SMT, Connector	APPROVED	Xavier	SCALE	1:1	UNLESS OTHERWISE SPECIFIED TOLERANCE	Dimension Tolerance	UNIT	mm	XXX	±0.25	SHEET	2/4	XXX	±0.15	SIZE	A4	XXX	±0.15	ANGLE	5°
CHECKED	Leon	NAME	SD7.0 express Card, Offset 1.8mm, Gold Flash with Shield SMT, Connector																									
APPROVED	Xavier	SCALE	1:1																									
UNLESS OTHERWISE SPECIFIED TOLERANCE	Dimension Tolerance	UNIT	mm																									
XXX	±0.25	SHEET	2/4																									
XXX	±0.15	SIZE	A4																									
XXX	±0.15	ANGLE	5°																									
<table border="1"> <tr> <td>PART NO.</td> <td>JCN-S71G-ULAN-XXXX6</td> <td>HF</td> <td>ROHS</td> </tr> <tr> <td>DOC. NO.</td> <td>JCN-S71G-ULAN-XXXX6</td> <td>THESE ARE ROHS COMPLIANT COMPONENTS</td> <td></td> </tr> </table>					PART NO.	JCN-S71G-ULAN-XXXX6	HF	ROHS	DOC. NO.	JCN-S71G-ULAN-XXXX6	THESE ARE ROHS COMPLIANT COMPONENTS																	
PART NO.	JCN-S71G-ULAN-XXXX6	HF	ROHS																									
DOC. NO.	JCN-S71G-ULAN-XXXX6	THESE ARE ROHS COMPLIANT COMPONENTS																										
<table border="1"> <tr> <td colspan="2">V-GENERAL TECHNOLOGY</td> <td colspan="3">維將科技股份有限公司</td> </tr> </table>					V-GENERAL TECHNOLOGY		維將科技股份有限公司																					
V-GENERAL TECHNOLOGY		維將科技股份有限公司																										

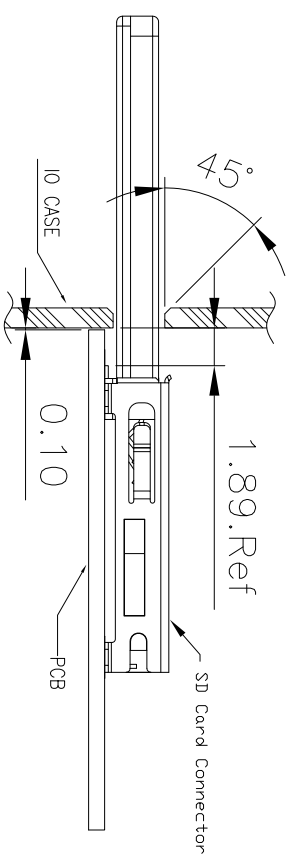

IO PANEL

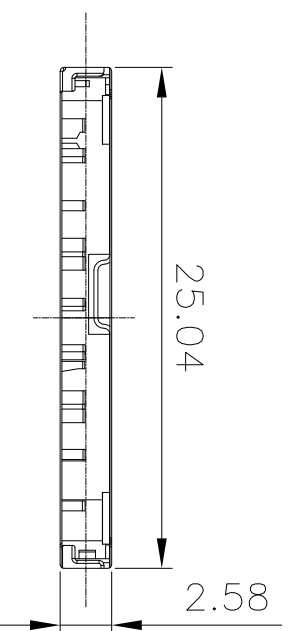

Panel Cut Out

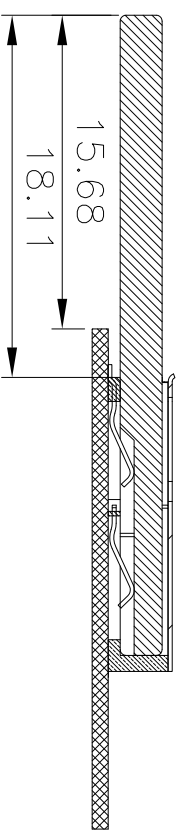

CARD INTO RECEPTACLE REPRESENT VIEW

(Side View)

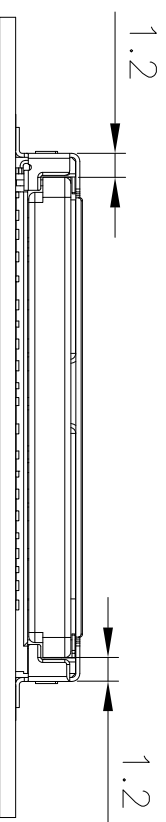

CARD INTO RECEPTACLE REPRESENT VIEW

(Front View)

CHECKED Leon		UNLESS OTHERWISE SPECIFIED TOLERANCE		NAME SD7.0 express Card, Orient 1.8mm, Gold Flash, With Shield SMT, Connector	
APPROVED Xv/ler		SCALE N/A		UNIT MM	
REV. X0		DIMENSION TUNGS TOLERANCE		SHEET 3/4	
X0		XXX		SIZE A4	
X0		XXX		SHEET	
X0		XXX		3/4	
ANGLE		±0.35			
		±0.25			
		±0.15			
		±5°			
		Material/Plated/Notes			
		①SHIELD : STAINLESS STEEL/NICKEL PLATING			
		②HOUSING : HIGH TEMPERATURE PLASTIC			
		③ CONTACTS : COPPER ALLOY/NICKEL			
		④ UNDERPLATED OVERALL GOLD FLASH			
		⑤ AT CONTACT AREAL/LEAD FREE TIN			
		ALLOY AT TERMINATION.			
PART NO.		DOC. NO.			
JCN-S71G-ULAN-XXXX		JCN-S71G-ULAN-XXXX6			

△X0	NEW DESIGN	DRAWN	MDDYY
MARK	REVISION RECORD	DRAWN	042021

Connector & Seaper Dimension

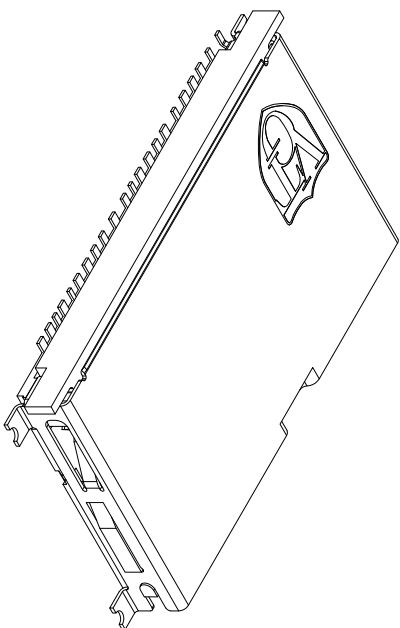
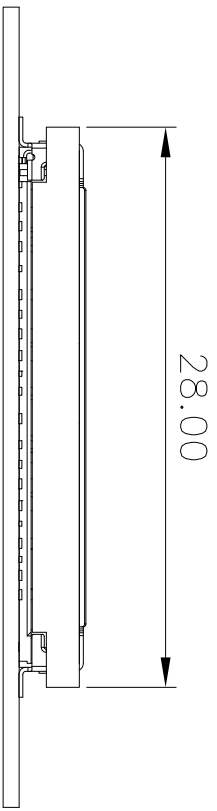
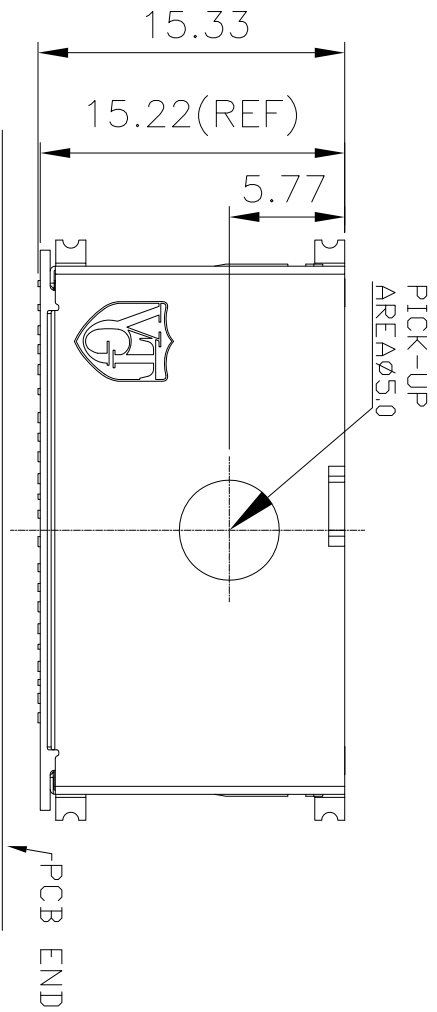

CHECKED Leon		UNLESS OTHERWISE SPECIFIED TOLERANCE		NAME SD7.0 express Card, Orient 1.8mm, Gold Finish, With Shield SMT, Connector	
APPROVED Xv/ef		Dimensional Tolerance		SCALE N/A	
REV. X0		XX	±0.35	SIZE A4	SHEET 4 / 4
MARK		XXX	±0.25	SHEET	
REVISION RECORD		ANGLE	±5°	SHEET	
NEW DESIGN		DRAWN		MATERIAL/PLATED/NOTES	
REVISION RECORD		DRAWN		①SHIELD : STAINLESS STEEL/NICKEL PLATING	
1		042021		②HOUSING : HIGH TEMPERATURE PLASTIC	
2				③CONTACTS : COPPER ALLOY/NICKEL UNDERPLATED OVERALL GOLD FLASH AT CONTACT AREAS/LEAD FREE TIN ALLOY AT TERMINATION.	
3				PART NO. JCN-S71G-ULAN-XXX6	
4				DOC. NO. JCN-S71G-ULAN-XXX6	
5					
E					